

W03590 S0006574836_V3

MR2059

Figure 401. Main Landing Gear Reaction Link Assembly Installation - Sheet 6
TASK 32-11-71-000-801

GAT 368

26/12/24

PARTIAL SIGN OFF STATUS:

Item: _____ Completed through item: _____ Sign: *[Signature]*

Item: _____ Completed through item: _____ Sign: _____

Rev # 44



Rev Date: Oct 17, 2024 PDT

GAT 168

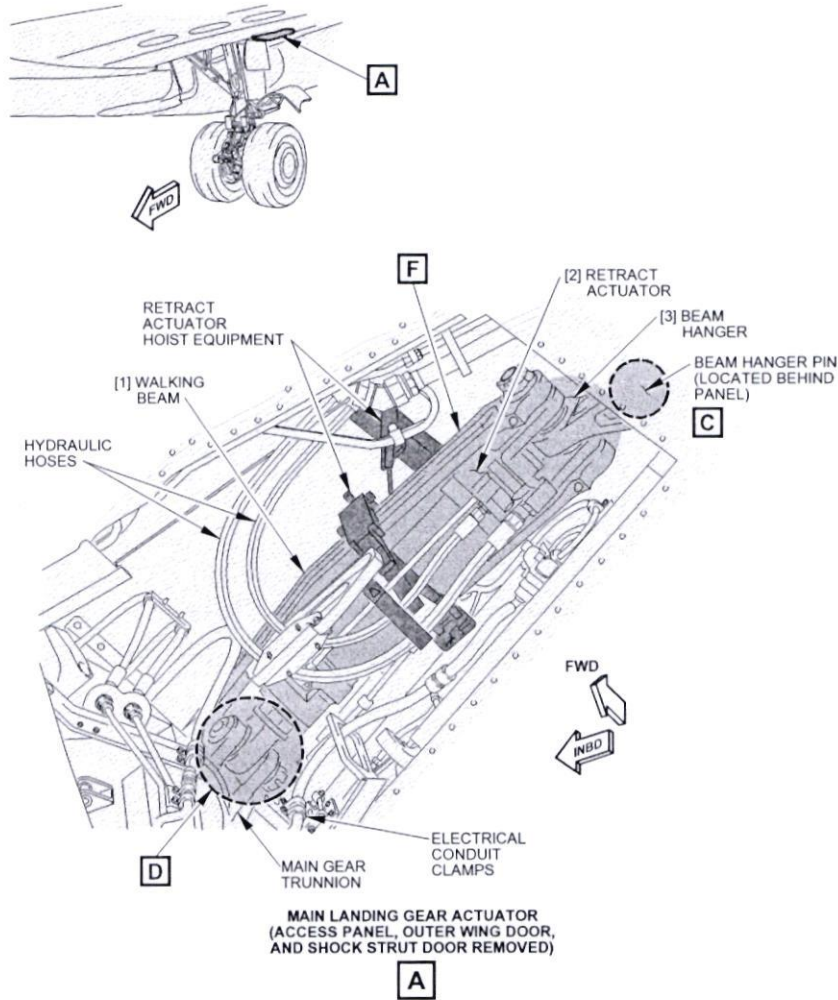

G20713 50006575180_V2

Handwritten: MR-2059

Figure 401. Main Gear Actuator Assembly Installation - Sheet 1
TASK 32-32-11-000-801

Stamp: GAT 308

Handwritten: 21/12/24

Stamp: GAT 308

Handwritten signature: [Signature]

PARTIAL SIGN OFF STATUS:

Item: _____ Completed through item: _____ Sign: _____

Item: _____ Completed through item: _____ Sign: _____

Rev # 44



Rev Date: Oct 17, 2024 PDT

GCAA APPROVAL No : UAE.145.1232

Left Main Landing Gear Restoration

Type: Routine Card

ATA: 32--

Flow: -

Work Area: -

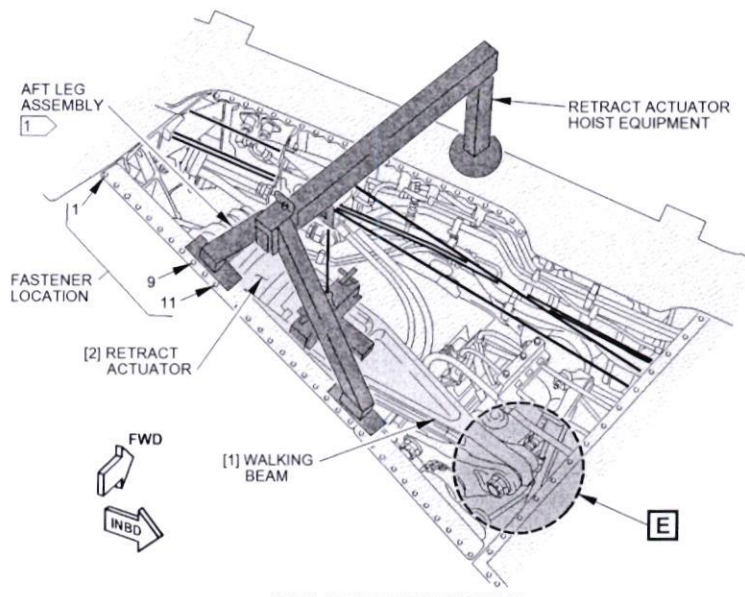
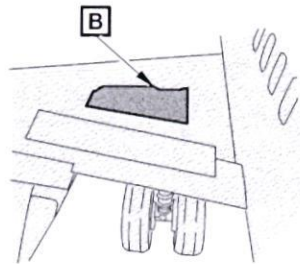

1 USE FASTENER LOCATIONS NUMBERS 9 AND 11 FOR THE AFT OUTBOARD LEG OF THE HOIST EQUIPMENT.

B

G20722 S0006575181_V2

MR2059

Figure 401. Main Gear Actuator Assembly Installation - Sheet 2
TASK 32-32-11-000-801

GAT 368

26/12/24
[Signature]

GAT 368

PARTIAL SIGN OFF STATUS:

Item: _____ Completed through item: _____ Sign: _____

Item: _____ Completed through item: _____ Sign: _____

Rev # 44



Rev Date: Oct 17, 2024 PDT

GCAA APPROVAL No : UAE.145.1232

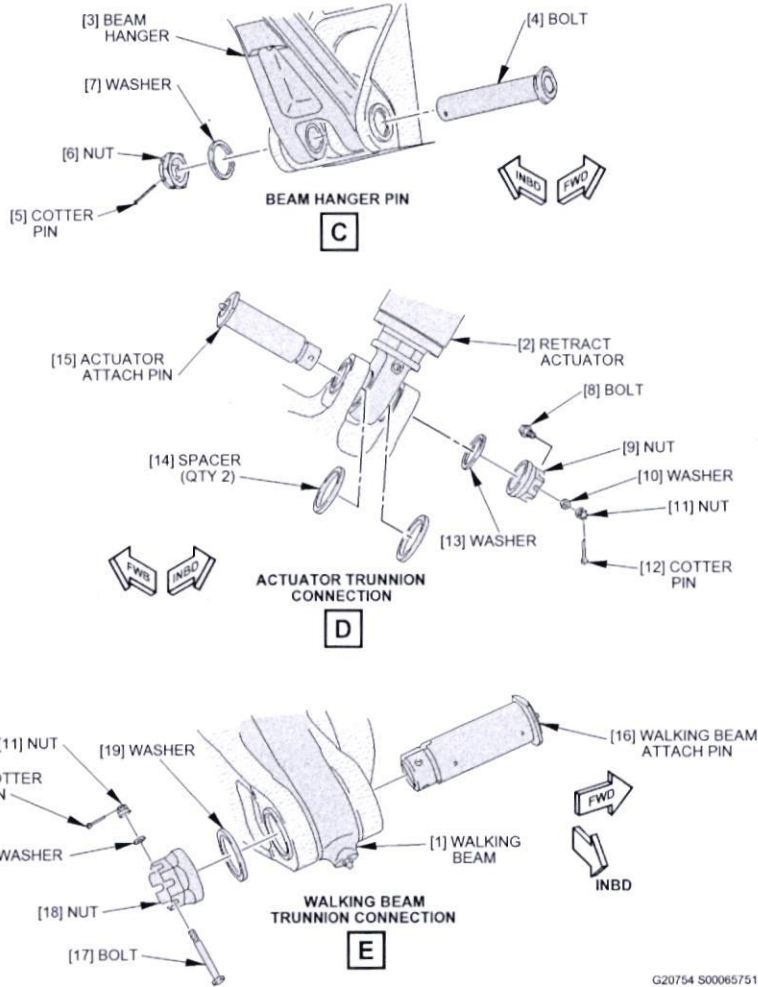

G20754 S0006575182_V2

Handwritten signature
MR 2029

Figure 401. Main Gear Actuator Assembly Installation - Sheet 3
TASK 32-32-11-000-801

Handwritten signature
26/12/24
GAT 368

PARTIAL SIGN OFF STATUS:

Item: _____ Completed through item: _____ Sign: _____
Item: _____ Completed through item: _____ Sign: _____

Rev # 44



Rev Date: Oct 17, 2024 PDT

GCAA APPROVAL No : UAE.145.1232

Handwritten signature
24/12/24
GAT 188

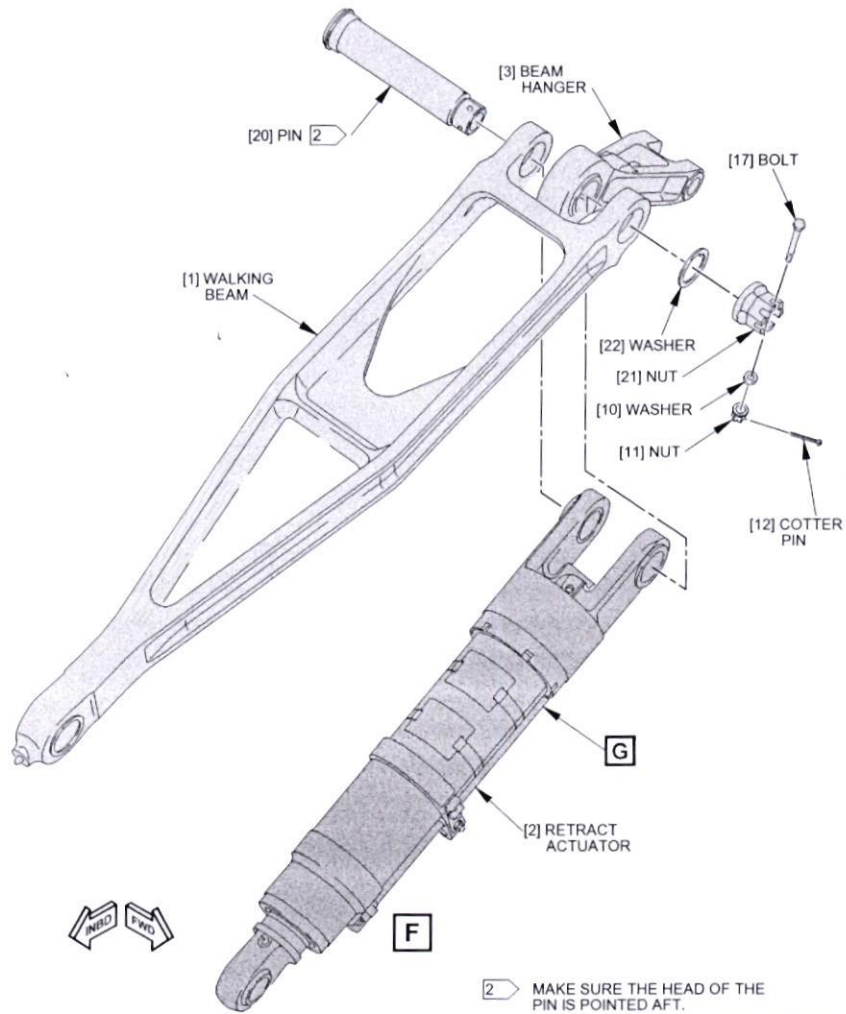

G20769 S0006575183_V2

MR2059

Figure 401. Main Gear Actuator Assembly Installation - Sheet 4
TASK 32-32-11-000-801

26/12/24
GAT 368

PARTIAL SIGN OFF STATUS:

Item: _____ Completed through item: _____ Sign: _____
Item: _____ Completed through item: _____ Sign: _____

Rev # 44



Rev Date: Oct 17, 2024 PDT

GCAA APPROVAL No : UAE.145.1232

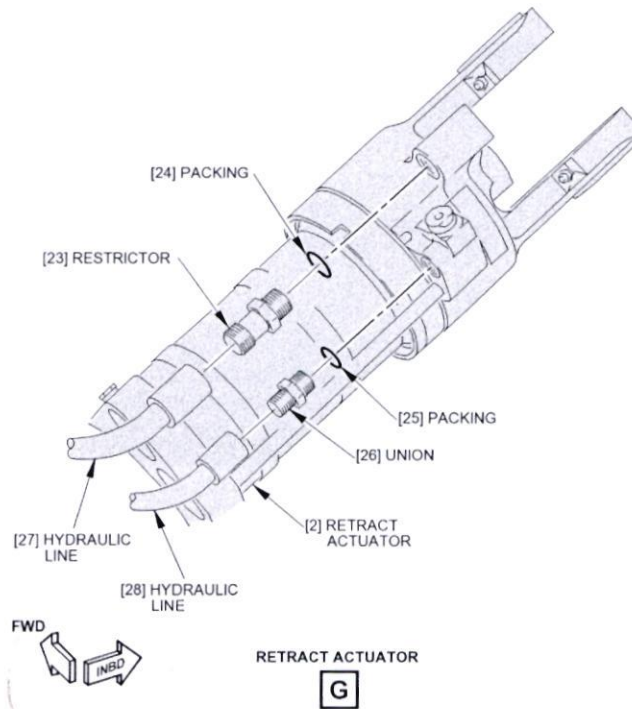

G21285 S0006575184_V3

Handwritten signature and date: 24/1/20

Figure 401. Main Gear Actuator Assembly Installation - Sheet 5
TASK 32-32-11-000-801

Handwritten signature and date: 26/12/24
GAT 368

PARTIAL SIGN OFF STATUS:

Item: _____ Completed through item: _____ Sign: _____

Item: _____ Completed through item: _____ Sign: _____

Rev # 44



Rev Date: Oct 17, 2024 PDT

GCAA APPROVAL No : UAE.145.1232

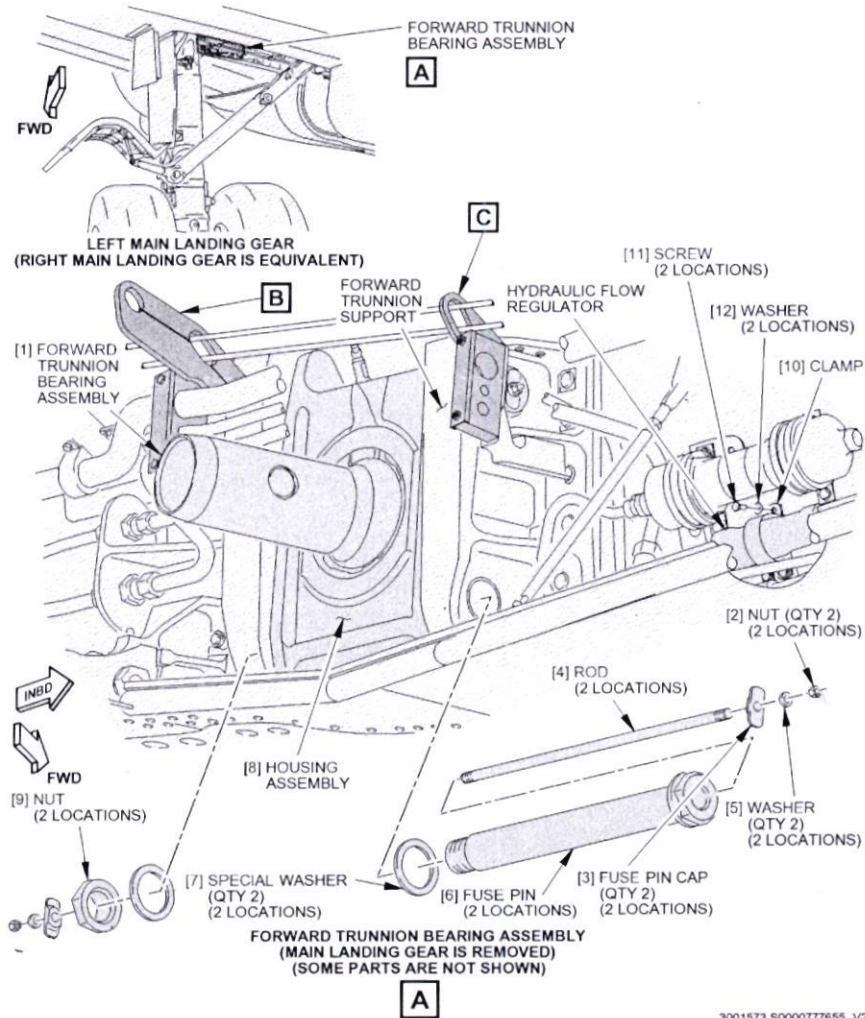

Handwritten signature

Figure 401. Main Landing Gear Forward Trunnion Bearing Assembly Installation - Sheet 1
TASK 32-11-83-000-801

Handwritten signature
25/12/24



PARTIAL SIGN OFF STATUS:

Item: _____ Completed through item: _____ Sign: _____

Item: _____ Completed through item: _____ Sign: _____



Left Main Landing Gear Restoration

Type: Routine Card

ATA: 32--

Flow:-

Work Area:-

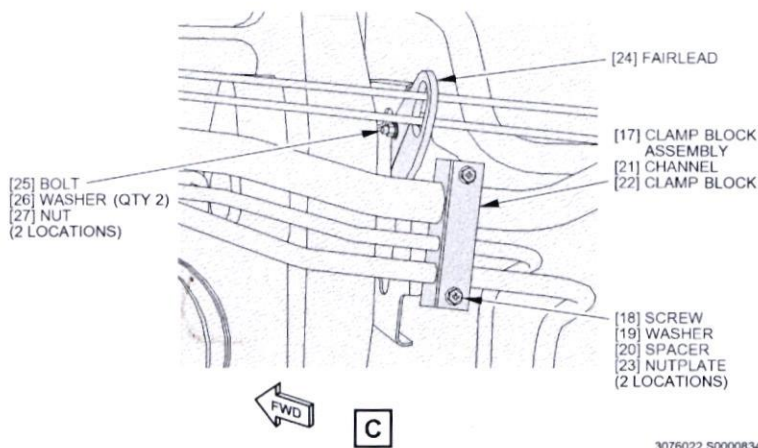
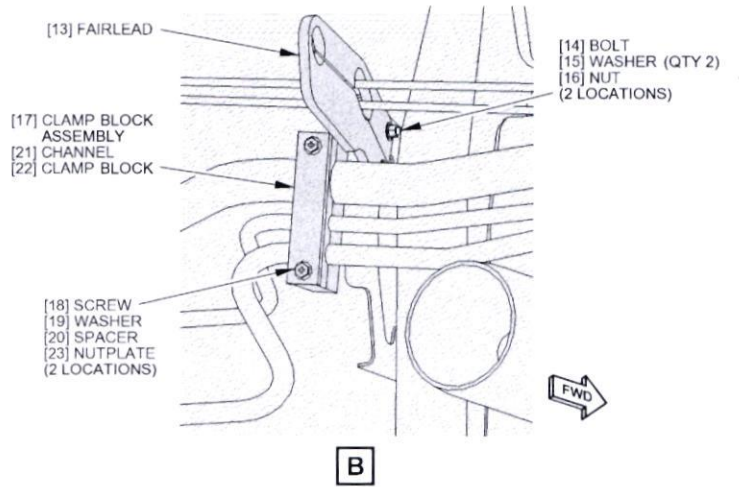

3076022 S0000834212_V1

M/1100

Figure 401. Main Landing Gear Forward Trunnion Bearing Assembly Installation - Sheet 2
TASK 32-11-83-000-801

26/12/24
GAT 368

PARTIAL SIGN OFF STATUS:

Item: _____ Completed through item: _____ Sign: _____
Item: _____ Completed through item: _____ Sign: _____

Rev # 44



Rev Date: Oct 17, 2024 PDT

GCAA APPROVAL No : UAE.145.1232

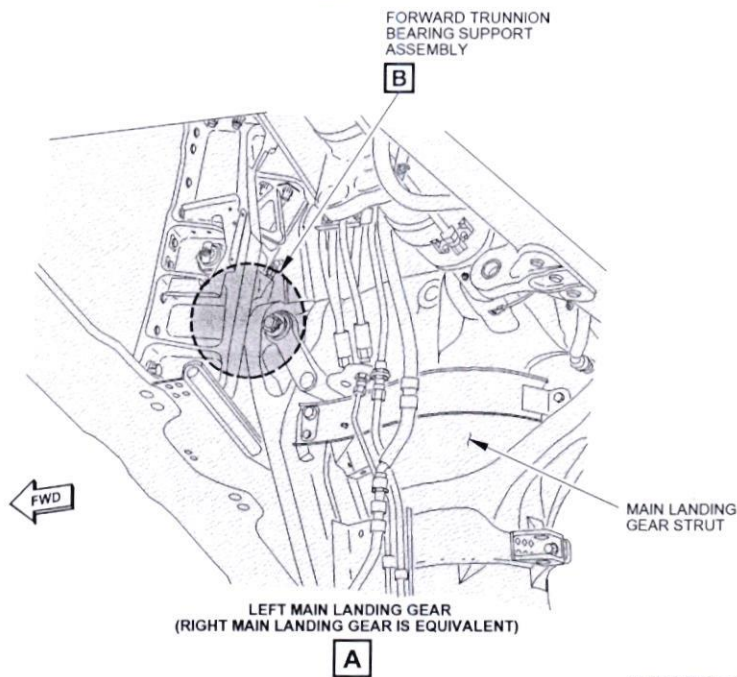
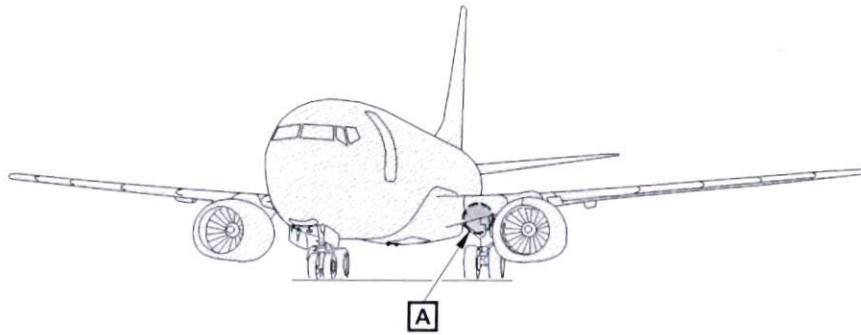

H86809 S0006581532_V2

M. P. 11/10

Figure 401. Forward Trunnion Housing Assembly Installation - Sheet 1
TASK 57-16-01-000-801

\$
26/12/29
GAT 368

PARTIAL SIGN OFF STATUS:

Item: _____ Completed through item: _____ Sign: _____

Item: _____ Completed through item: _____ Sign: _____

Rev # 44



Rev Date: Oct 17, 2024 PDT

Type: Routine Card

ATA: 32--

Flow: -

Work Area: -

FIG. EFFECTIVITY: JXB AMM EFFECTIVITY 004, 005, 007-009, 014 PRE SB 737-32-1448

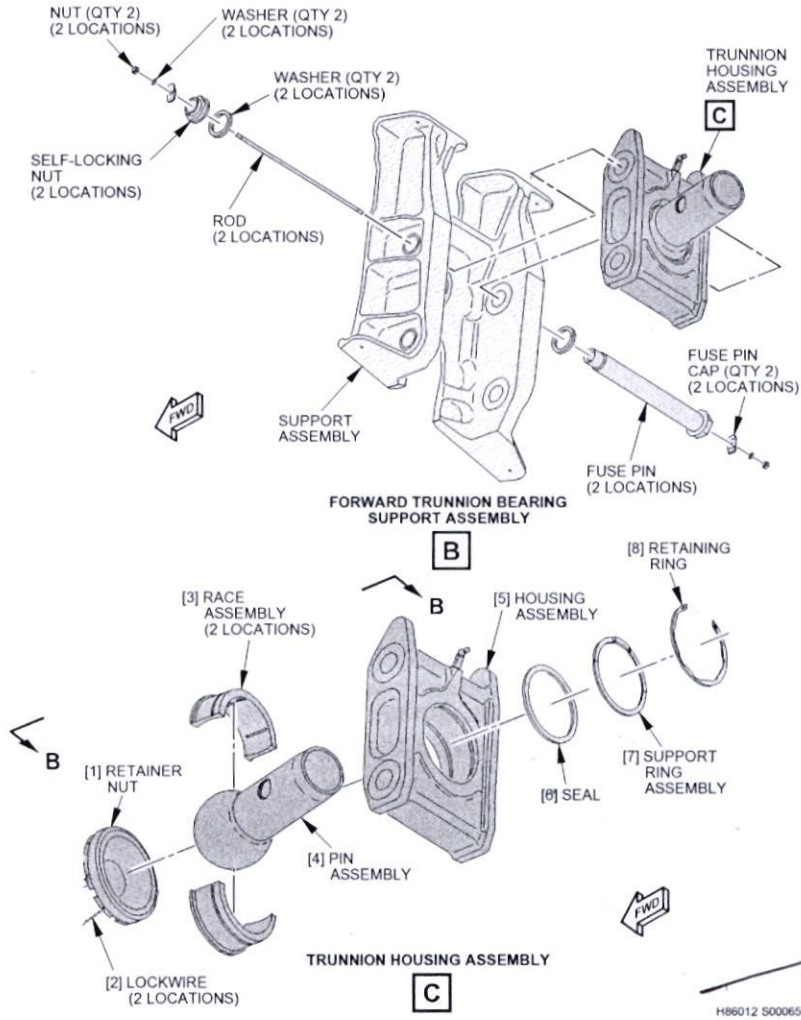

H86012 50006581533_V5

Handwritten signature

Figure 401. Forward Trunnion Housing Assembly Installation - Sheet 2
TASK 57-16-01-000-801

Handwritten signature
GAT 368

PARTIAL SIGN OFF STATUS:

Item: _____ Completed through item: _____ Sign: _____

Item: _____ Completed through item: _____ Sign: _____

Rev # 44



Rev Date: Oct 17, 2024 PDT

GCAA APPROVAL No : UAE.145.1232

FIG. EFFECTIVITY: JXB AMM EFFECTIVITY 026-031, 033, 036, 037, 040-051, 053-999; JXB 004, 005, 007-009, 014 POST SB 737-32-1448

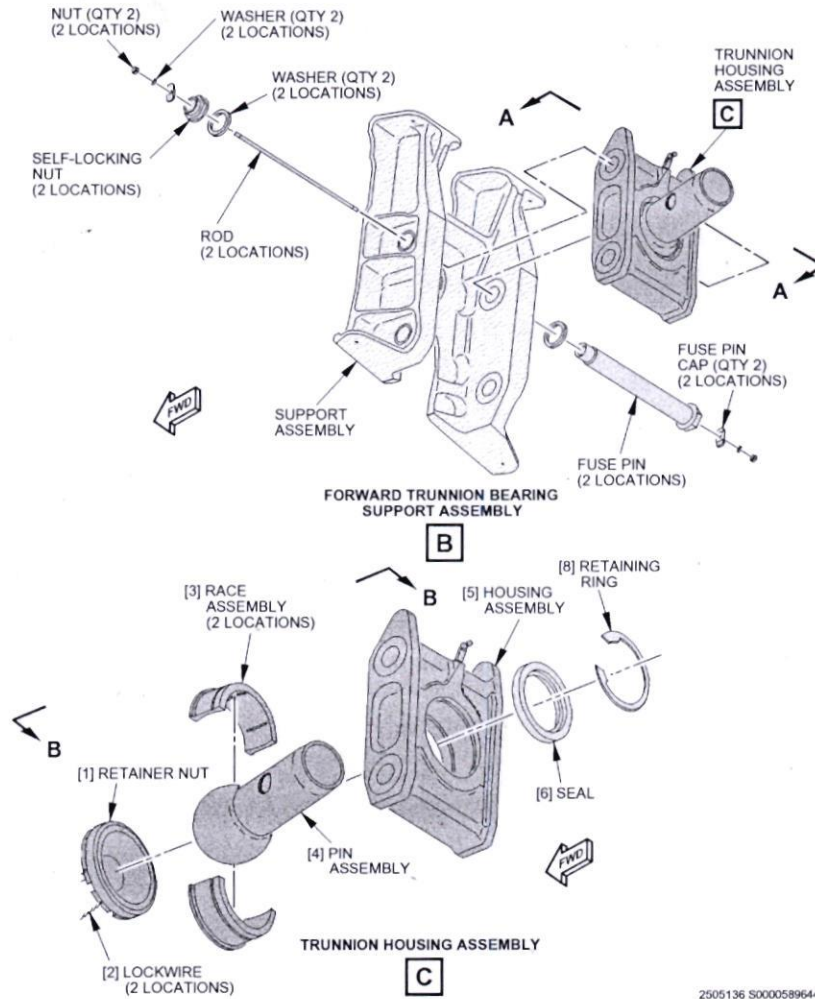

M PIA

Figure 401. Forward Trunnion Housing Assembly Installation - Sheet 3
TASK 57-16-01-000-801

25/12/20

PARTIAL SIGN OFF STATUS:

Item: _____ Completed through item: _____ Sign: _____

Item: _____ Completed through item: _____ Sign: _____



Rev # 44



Rev Date: Oct 17, 2024 PDT

GCAA APPROVAL No : UAE.145.1232

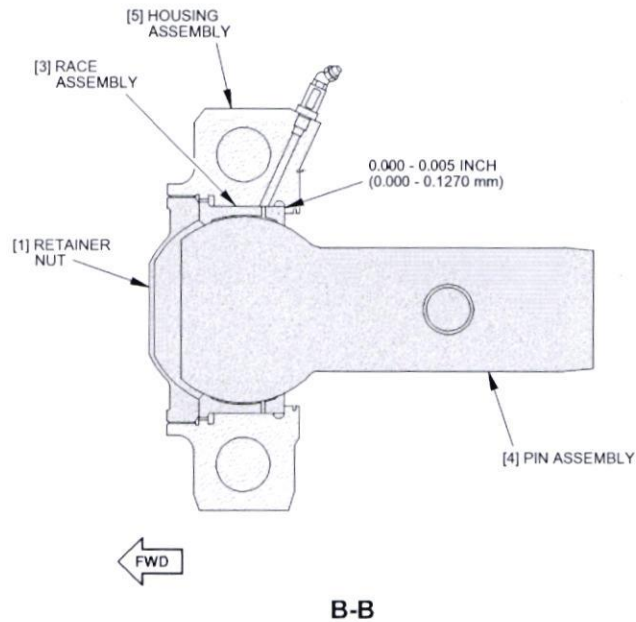

3013172 S0000786750_V1

M 11/100

Figure 401. Forward Trunnion Housing Assembly Installation - Sheet 4
TASK 57-16-01-000-801

25/12/24
GAT 368

PARTIAL SIGN OFF STATUS:

Item: _____ Completed through item: _____ Sign: _____

Item: _____ Completed through item: _____ Sign: _____



FIG. EFFECTIVITY: JXB AMM EFFECTIVITY 026-031, 033, 036, 037, 040-051, 053-999; JXB 004, 005, 007-009, 014 POST SB 737-32-1448

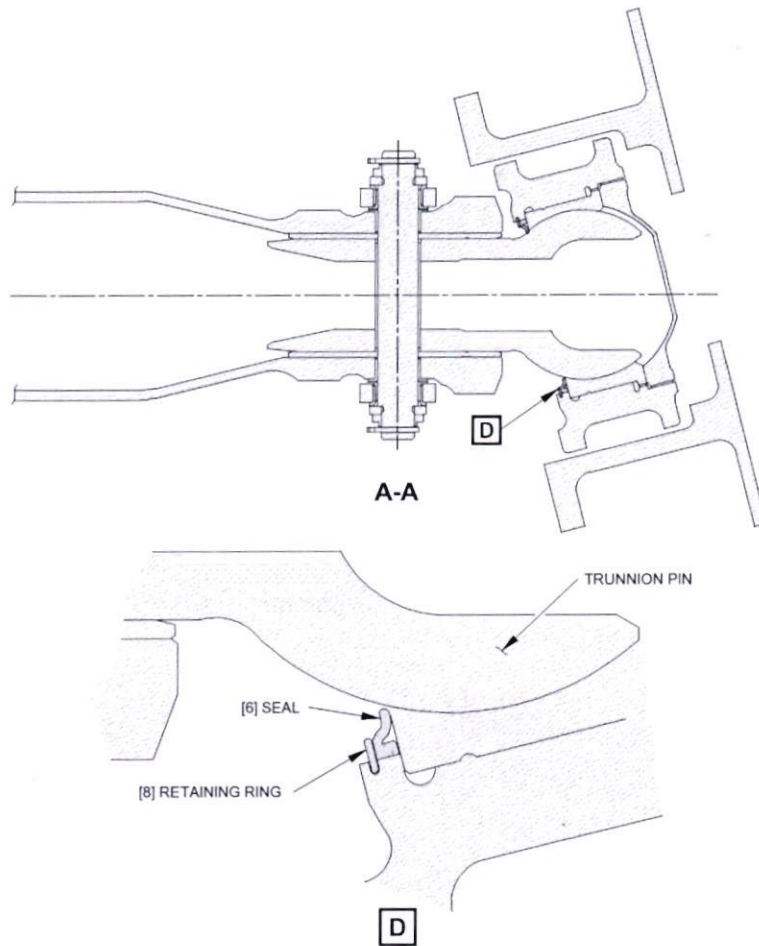

2554049 50000608759_V1

Mellor

Figure 401. Forward Trunnion Housing Assembly Installation - Sheet 5
TASK 57-16-01-000-801

25/12/20
GAT
368

PARTIAL SIGN OFF STATUS:

Item: _____ Completed through item: _____ Sign: _____
Item: _____ Completed through item: _____ Sign: _____

Rev # 44



Rev Date: Oct 17, 2024 PDT

GCAA APPROVAL No : UAE.145.1232

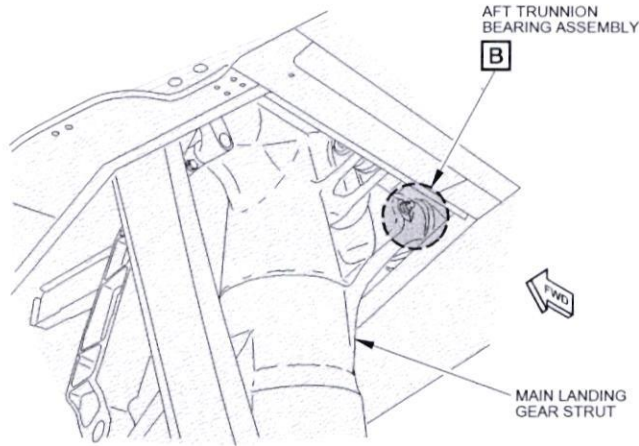
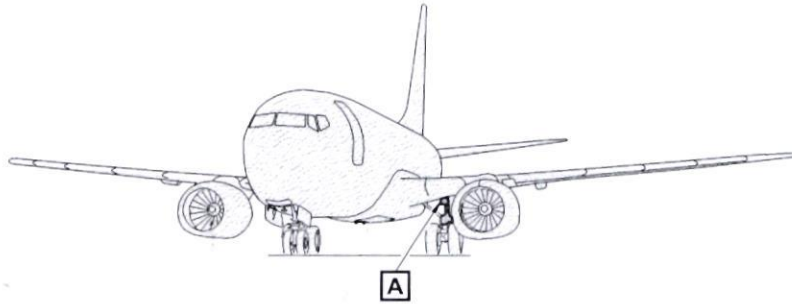

LEFT MAIN LANDING GEAR
(RIGHT MAIN LANDING GEAR IS EQUIVALENT)

A

K22407 S0006581544_V2

Handwritten signature

Figure 401. MLG Aft Trunnion Bearing Assembly Installation - Sheet 1
TASK 57-16-02-000-801

GAT
368

Handwritten signature
25/12/24

PARTIAL SIGN OFF STATUS:

Item: _____ Completed through item: _____ Sign: _____

Item: _____ Completed through item: _____ Sign: _____

Rev # 44



Rev Date: Oct 17, 2024 PDT

GCAA APPROVAL No : UAE.145.1232

Left Main Landing Gear Restoration

Type: Routine Card

ATA: 32--

Flow: -

Work Area: -

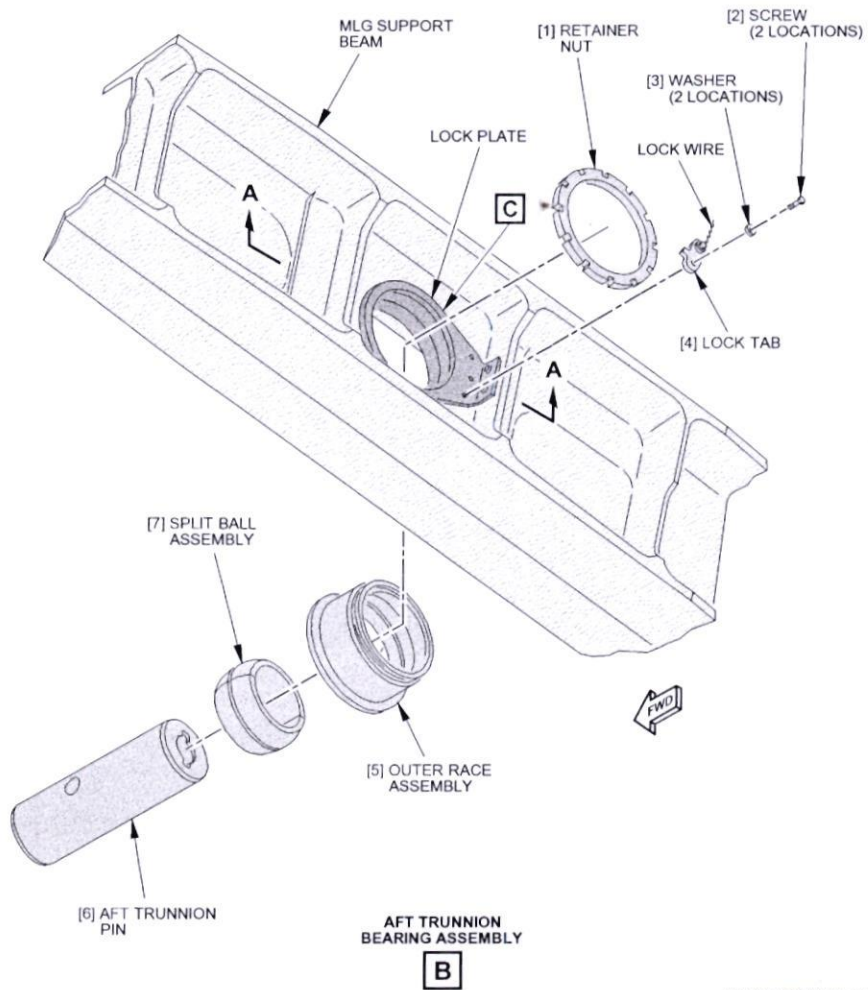

K22428 S0006581545_V4

MRIW

Figure 401. MLG Aft Trunnion Bearing Assembly Installation - Sheet 2
TASK 57-16-02-000-801

29/12/24
GAT 368

PARTIAL SIGN OFF STATUS:

Item: _____ Completed through item: _____ Sign: _____

Item: _____ Completed through item: _____ Sign: _____

Rev # 44



Rev Date: Oct 17, 2024 PDT

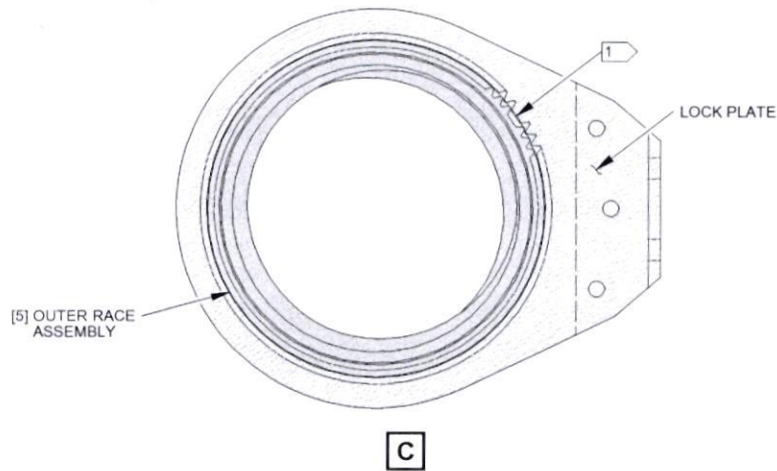
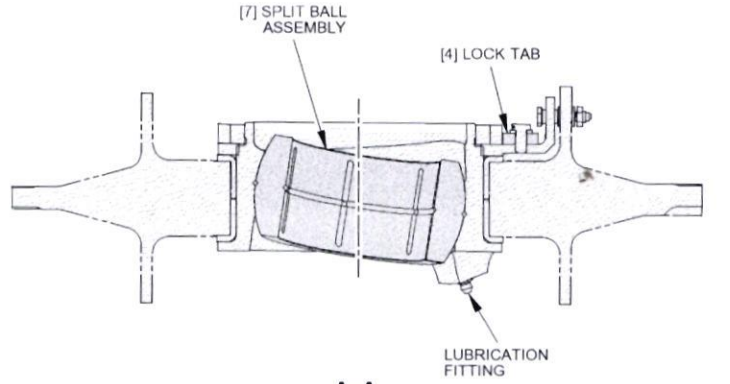

1 THE WIDER SPLINES OF THE OUTER RACE ASSEMBLY AND THE LOCK PLATE MUST BE ALIGNED.

2557362 S0000609931_V2

MMAW

25/12/24

GAT 368

Figure 401. MLG Aft Trunnion Bearing Assembly Installation - Sheet 3
TASK 57-16-02-000-801

PARTIAL SIGN OFF STATUS:

Item: _____ Completed through item: _____ Sign: _____

Item: _____ Completed through item: _____ Sign: _____



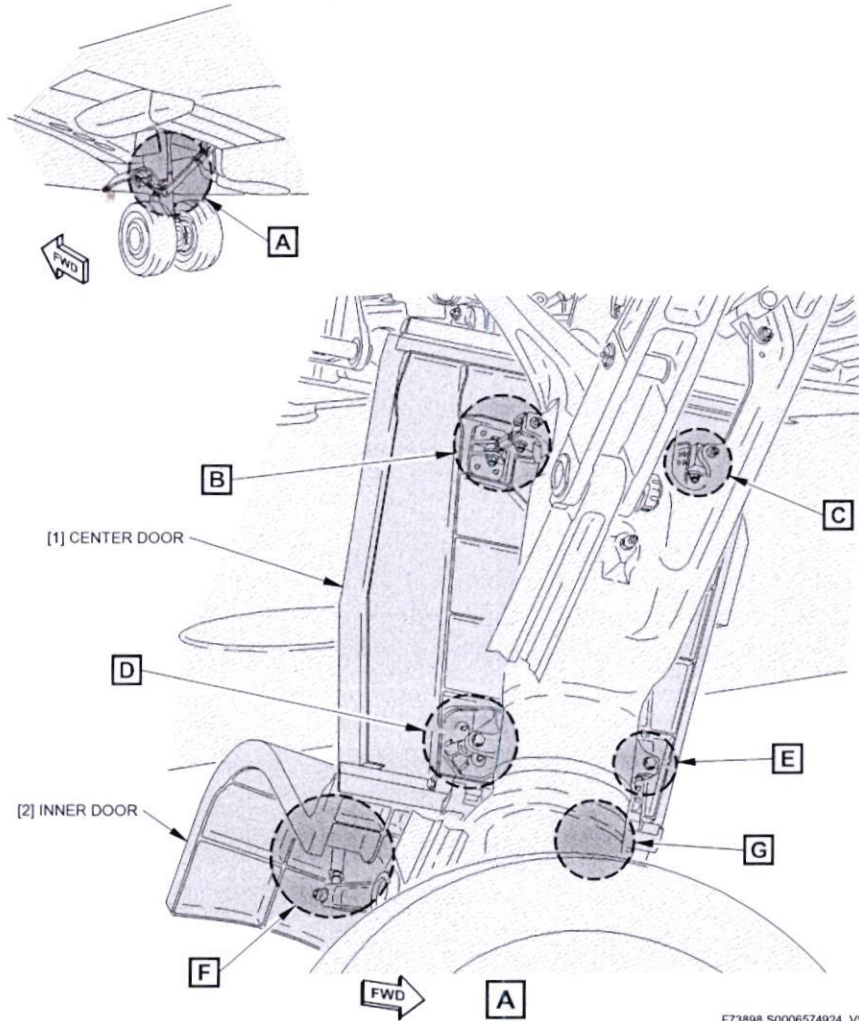

Mellor

Figure 401. Main Landing Gear Shock Strut Doors Installation - Sheet 1
TASK 32-11-00-400-801

27/12/24
GAT
368

PARTIAL SIGN OFF STATUS:

Item: _____ Completed through item: _____ Sign: _____

Item: _____ Completed through item: _____ Sign: _____

Rev # 44



Rev Date: Oct 17, 2024 PDT

Left Main Landing Gear Restoration

Type: Routine Card

ATA: 32--

Flow: -

Work Area: -

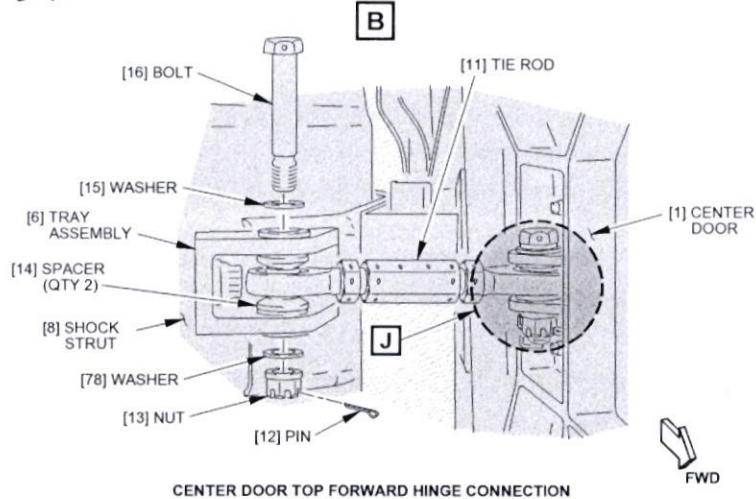
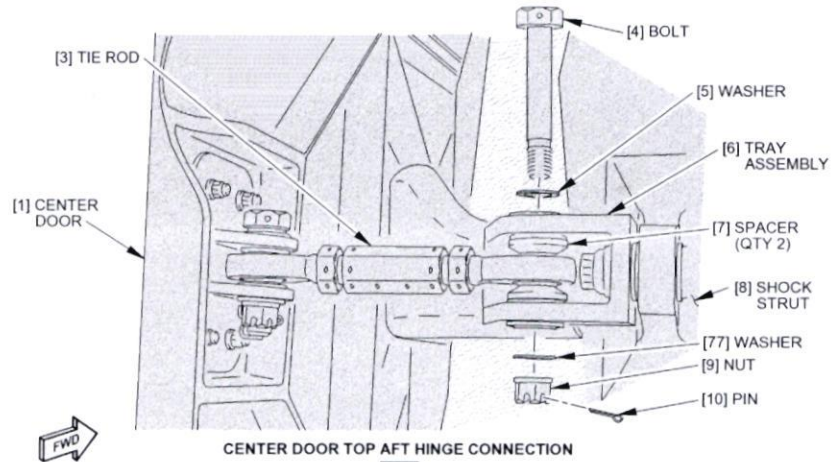

F74093 S0006574925_V5

Handwritten signature

Handwritten signature
 GAT 368
 28/12/24

Figure 401. Main Landing Gear Shock Strut Doors Installation - Sheet 2
 TASK 32-11-00-400-801

PARTIAL SIGN OFF STATUS:

Item: _____ Completed through item: _____ Sign: _____
 Item: _____ Completed through item: _____ Sign: _____

Rev # 44



Rev Date: Oct 17, 2024 PDT

GCAA APPROVAL No : UAE.145.1232

FIG. EFFECTIVITY: JXB AMM EFFECTIVITY 036, 037, 040-051, 053-999 PRE SB 737-52-1170 MODIFICATION

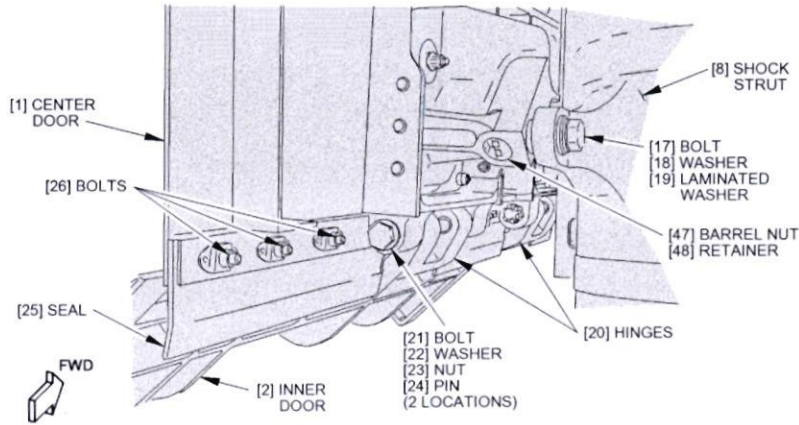

CENTER DOOR BOTTOM AFT HINGE CONNECTION

D

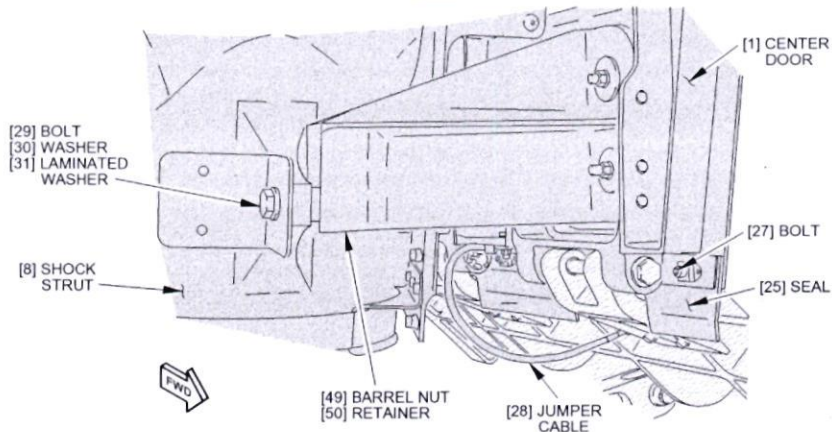

CENTER DOOR BOTTOM FORWARD HINGE CONNECTION

E

F74190 S0006574926_V6

MRIW

Figure 401. Main Landing Gear Shock Strut Doors Installation - Sheet 3
TASK 32-11-00-400-801

27/12/24
GAT 368

PARTIAL SIGN OFF STATUS:

Item: _____ Completed through item: _____ Sign: _____

Item: _____ Completed through item: _____ Sign: _____



Left Main Landing Gear Restoration

Type: Routine Card

ATA: 32--

Flow: -

Work Area: -

FIG. EFFECTIVITY: JXB AMM EFFECTIVITY 004, 005, 007-009, 014, 028, 029 PRE SB
737-52-1170 MODIFICATION

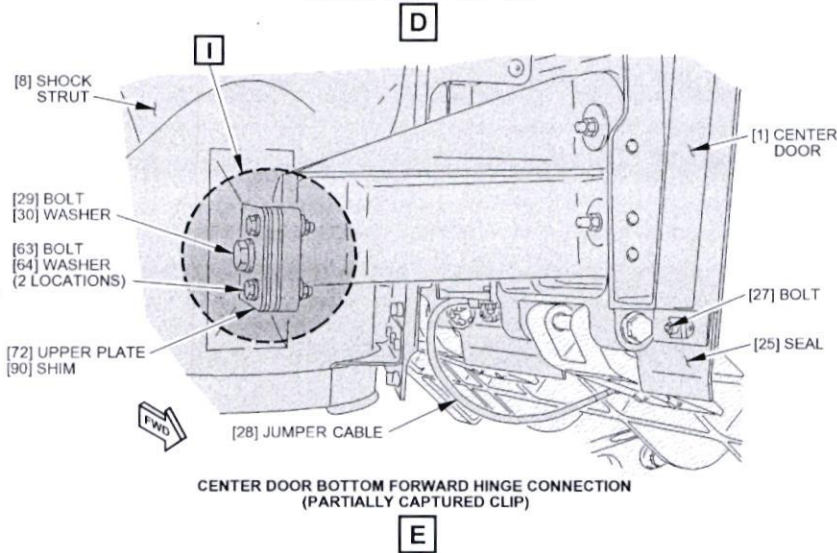
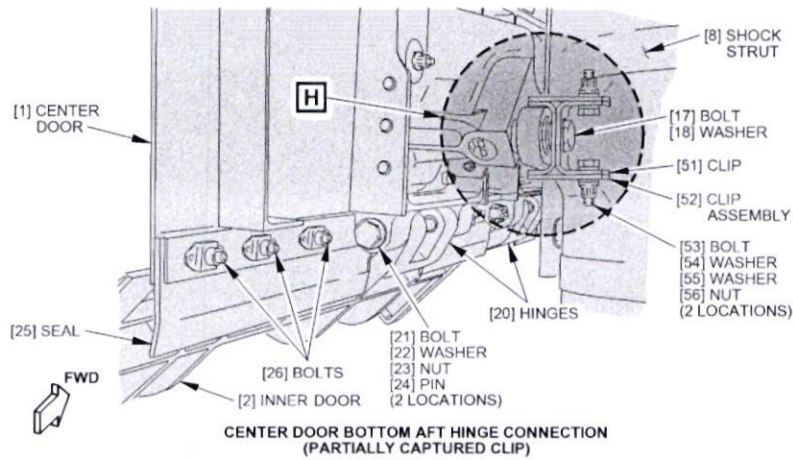

K26037 S0006574927_V7

M. M. M. M.

GAT
368
27/12/24

Figure 401. Main Landing Gear Shock Strut Doors Installation - Sheet 4
TASK 32-11-00-400-801

PARTIAL SIGN OFF STATUS:

Item: _____ Completed through item: _____ Sign: _____

Item: _____ Completed through item: _____ Sign: _____

Rev # 44



Rev Date: Oct 17, 2024 PDT

GCAA APPROVAL No : UAE.145.1232