

W03590 S0006574836\_V3

MR2059

Figure 401. Main Landing Gear Reaction Link Assembly Installation - Sheet 6  
TASK 32-11-71-000-801

GAT 368  
26/12/24

PARTIAL SIGN OFF STATUS:

Item: \_\_\_\_\_ Completed through item: \_\_\_\_\_ Sign: *[Signature]*

Item: \_\_\_\_\_ Completed through item: \_\_\_\_\_ Sign: \_\_\_\_\_

Rev # 44



Rev Date: Oct 17, 2024 PDT

GAT 168

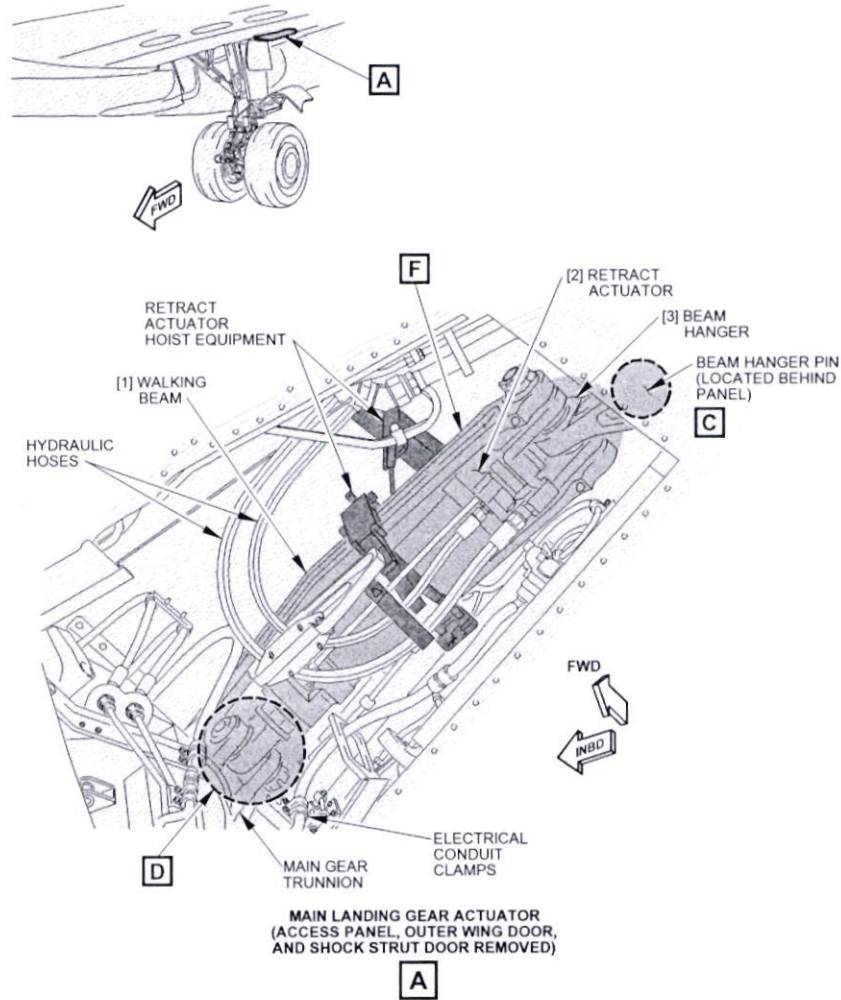

G20713 50006575180\_V2

*Handwritten:* MR-2059

Figure 401. Main Gear Actuator Assembly Installation - Sheet 1  
TASK 32-32-11-000-801

*Stamp:* GAT 308

*Handwritten:* 21/12/24 26/12/24

*Stamp:* GAT 308

*Handwritten signature:* [Signature]

PARTIAL SIGN OFF STATUS:

Item: \_\_\_\_\_ Completed through item: \_\_\_\_\_ Sign: \_\_\_\_\_

Item: \_\_\_\_\_ Completed through item: \_\_\_\_\_ Sign: \_\_\_\_\_

Rev # 44



Rev Date: Oct 17, 2024 PDT

GCAA APPROVAL No : UAE.145.1232

Left Main Landing Gear Restoration

Type: Routine Card

ATA: 32--

Flow: -

Work Area: -

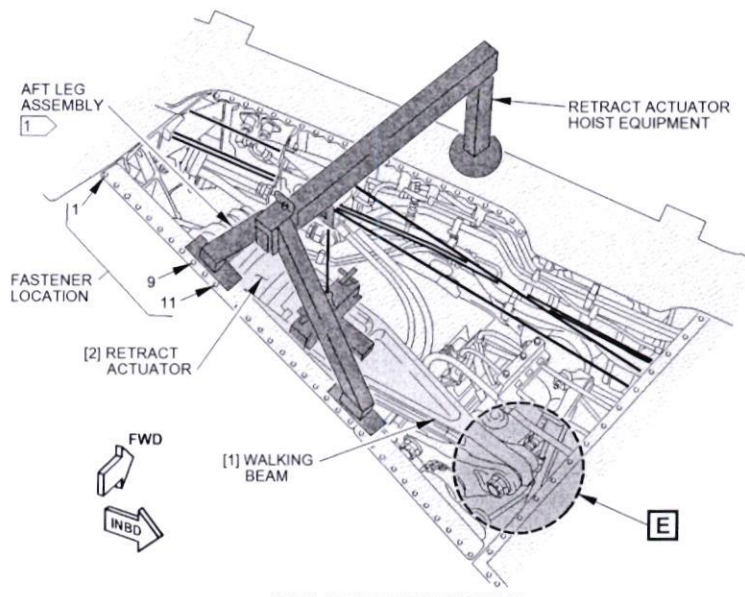
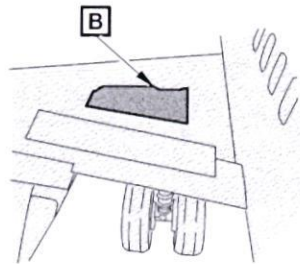

MAIN LANDING GEAR ACTUATOR  
(ACCESS PANEL REMOVED AND RETRACT  
ACTUATOR HOIST TOOL INSTALLED)

**1** USE FASTENER LOCATIONS NUMBERS 9 AND 11  
FOR THE AFT OUTBOARD LEG OF THE HOIST  
EQUIPMENT.

**B**

G20722 S0006575181\_V2

*MR2059*

Figure 401. Main Gear Actuator Assembly Installation - Sheet 2  
TASK 32-32-11-000-801

**GAT 368**

*26/12/24*  
*[Signature]*

**GAT 368**

PARTIAL SIGN OFF STATUS:

Item: \_\_\_\_\_ Completed through item: \_\_\_\_\_ Sign: \_\_\_\_\_

Item: \_\_\_\_\_ Completed through item: \_\_\_\_\_ Sign: \_\_\_\_\_

Rev # 44



Rev Date: Oct 17, 2024 PDT

GCAA APPROVAL No : UAE.145.1232

Left Main Landing Gear Restoration

Type: Routine Card

ATA: 32--

Flow: -

Work Area: -

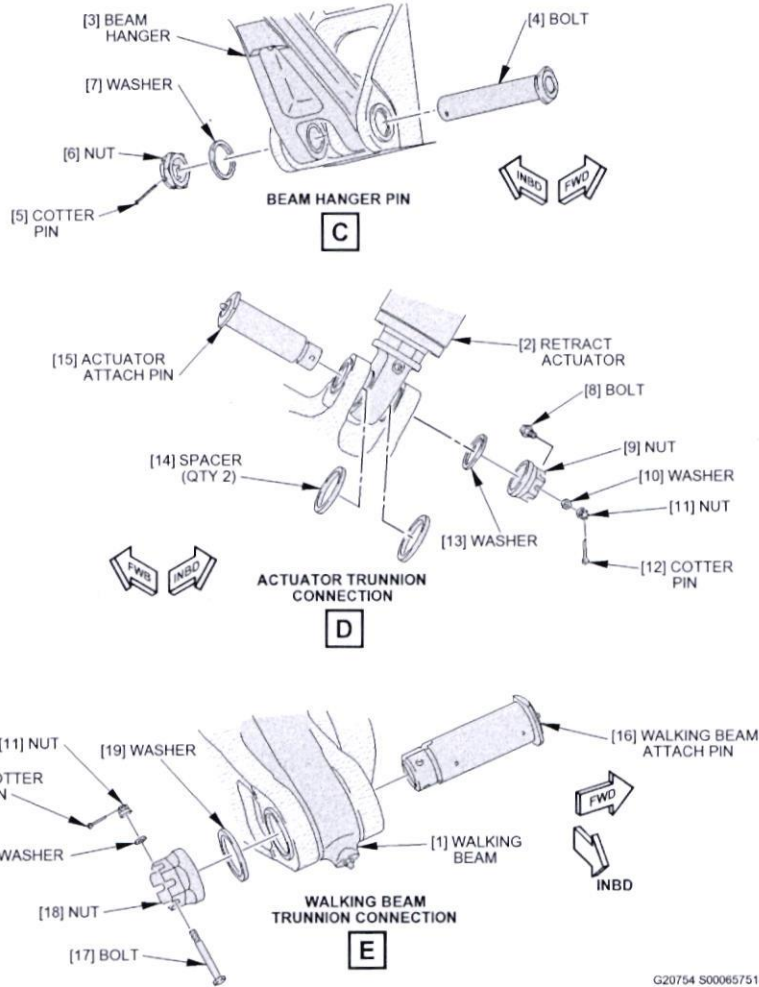

G20754 S0006575182\_V2

*Handwritten signature*  
MR 2029

Figure 401. Main Gear Actuator Assembly Installation - Sheet 3  
TASK 32-32-11-000-801

*Handwritten signature*  
26/12/24  
GAT 368

PARTIAL SIGN OFF STATUS:

Item: \_\_\_\_\_ Completed through item: \_\_\_\_\_ Sign: \_\_\_\_\_

Item: \_\_\_\_\_ Completed through item: \_\_\_\_\_ Sign: \_\_\_\_\_

Rev # 44



Rev Date: Oct 17, 2024 PDT

GCAA APPROVAL No : UAE.145.1232

*Handwritten signature*  
24/12/24  
GAT 188

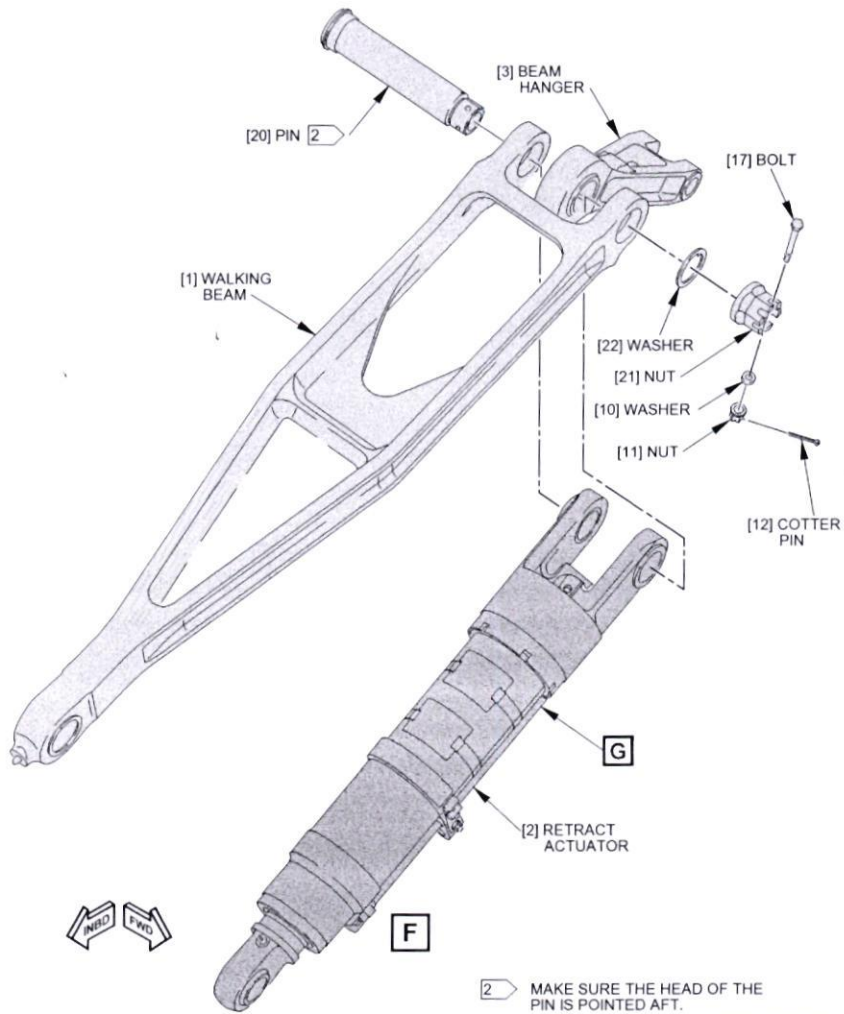

MR2059

Figure 401. Main Gear Actuator Assembly Installation - Sheet 4  
TASK 32-32-11-000-801

26/12/24  
GAT 368

PARTIAL SIGN OFF STATUS:

Item: \_\_\_\_\_ Completed through item: \_\_\_\_\_ Sign: \_\_\_\_\_  
Item: \_\_\_\_\_ Completed through item: \_\_\_\_\_ Sign: \_\_\_\_\_

Rev # 44



Rev Date: Oct 17, 2024 PDT

GCAA APPROVAL No : UAE.145.1232

Left Main Landing Gear Restoration

Type: Routine Card

ATA: 32--

Flow: -

Work Area: -

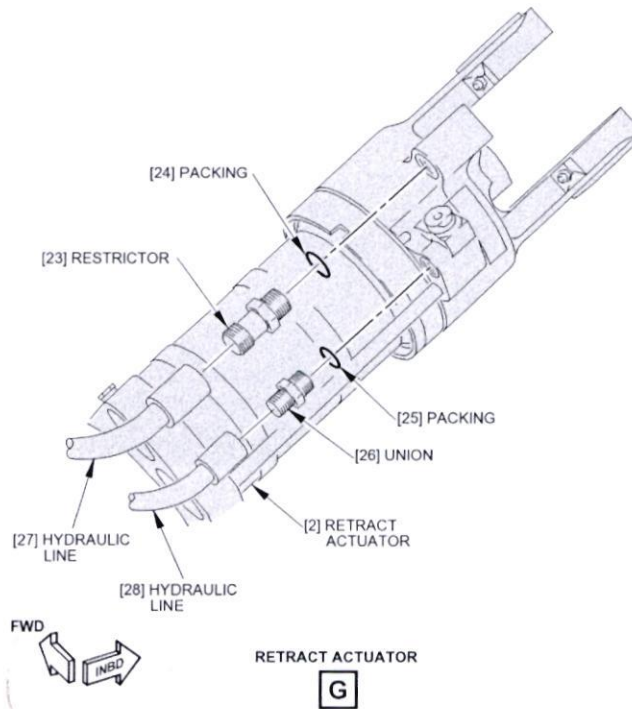

G21285 S0006575184\_V3

*Handwritten signature and date: 24/1/20*

Figure 401. Main Gear Actuator Assembly Installation - Sheet 5  
TASK 32-32-11-000-801

*Handwritten signature and date: 26/12/24*  
**GAT 368**

**PARTIAL SIGN OFF STATUS:**

Item: \_\_\_\_\_ Completed through item: \_\_\_\_\_ Sign: \_\_\_\_\_

Item: \_\_\_\_\_ Completed through item: \_\_\_\_\_ Sign: \_\_\_\_\_

Rev # 44



Rev Date: Oct 17, 2024 PDT

GCAA APPROVAL No : UAE.145.1232

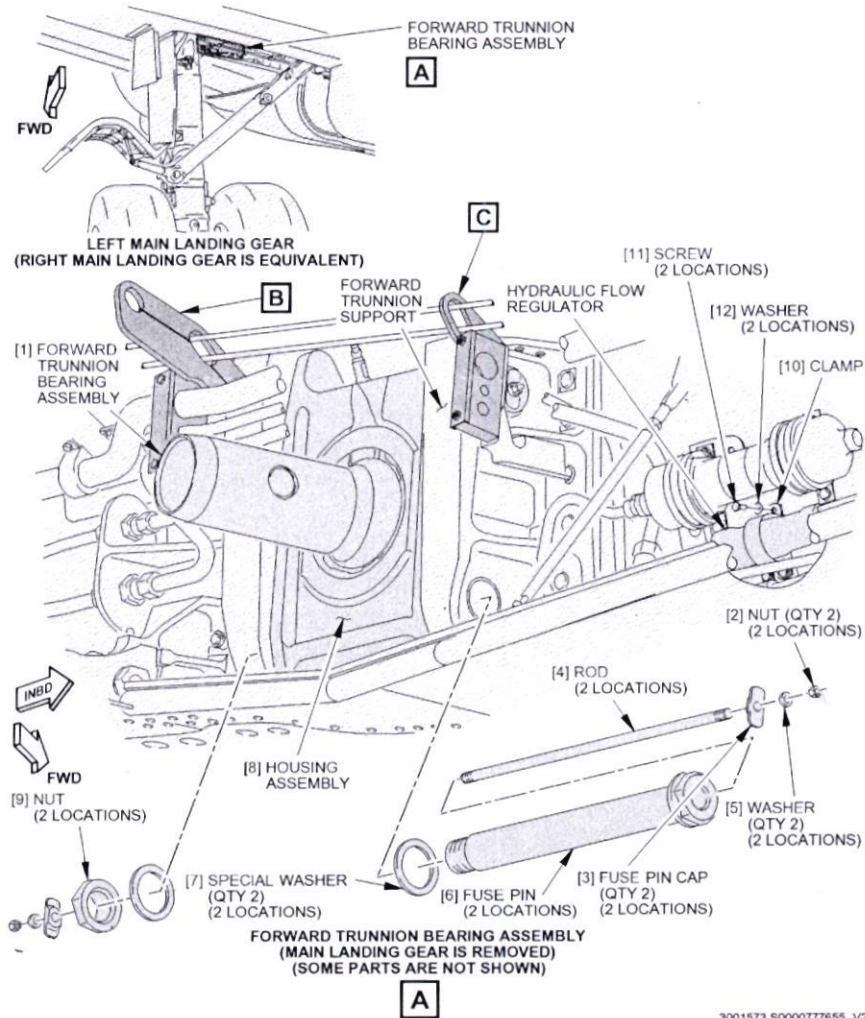

3001573 5000077655\_V2

*Handwritten signature*  
M 21/100

Figure 401. Main Landing Gear Forward Trunnion Bearing Assembly Installation - Sheet 1  
TASK 32-11-83-000-801

*Handwritten signature*  
25/12/24



PARTIAL SIGN OFF STATUS:

Item: \_\_\_\_\_ Completed through item: \_\_\_\_\_ Sign: \_\_\_\_\_

Item: \_\_\_\_\_ Completed through item: \_\_\_\_\_ Sign: \_\_\_\_\_

Rev # 44



Rev Date: Oct 17, 2024 PDT

GCAA APPROVAL No : UAE.145.1232

Left Main Landing Gear Restoration

Type: Routine Card

ATA: 32--

Flow:-

Work Area:-

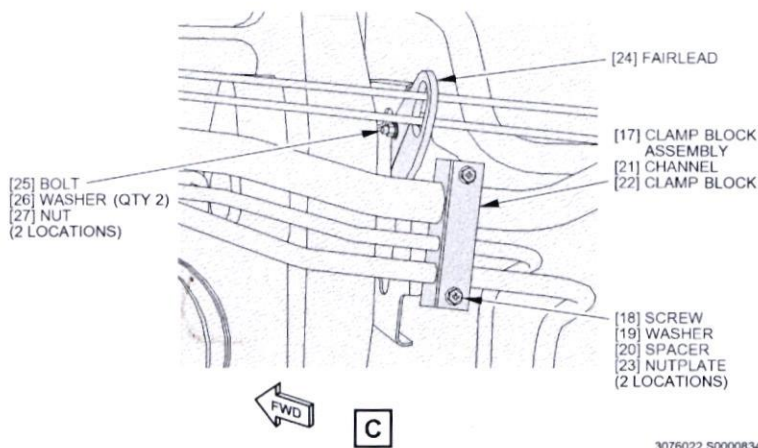
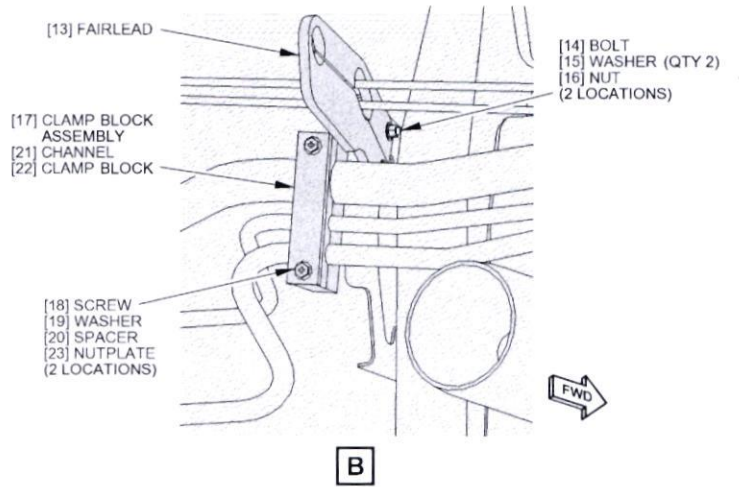

3076022 S0000834212\_V1

*M/1100*

Figure 401. Main Landing Gear Forward Trunnion Bearing Assembly Installation - Sheet 2  
TASK 32-11-83-000-801

*26/12/24*  
*GAT 368*

PARTIAL SIGN OFF STATUS:

Item: \_\_\_\_\_ Completed through item: \_\_\_\_\_ Sign: \_\_\_\_\_  
Item: \_\_\_\_\_ Completed through item: \_\_\_\_\_ Sign: \_\_\_\_\_

Rev # 44



Rev Date: Oct 17, 2024 PDT

GCAA APPROVAL No : UAE.145.1232

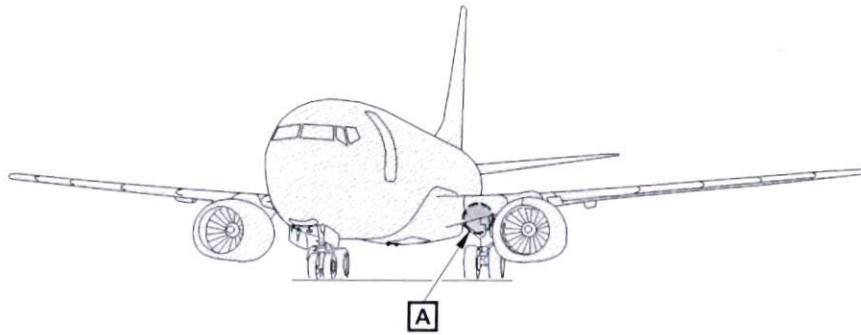

FORWARD TRUNNION BEARING SUPPORT ASSEMBLY

B

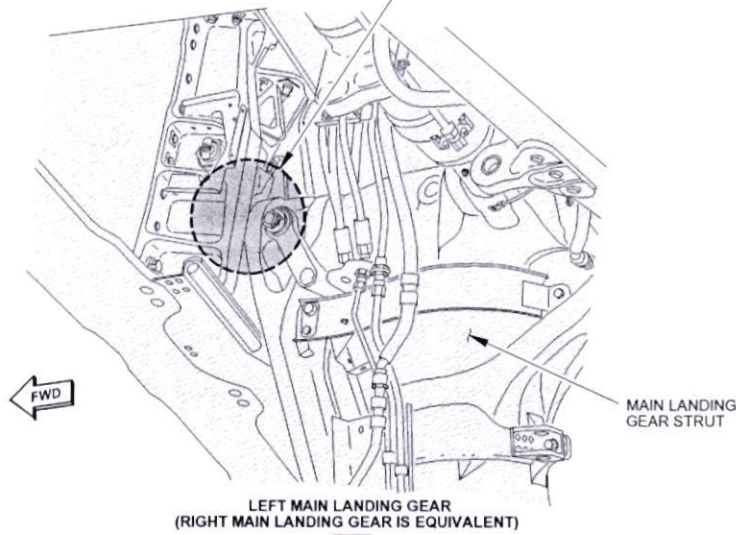

LEFT MAIN LANDING GEAR (RIGHT MAIN LANDING GEAR IS EQUIVALENT)

A

H86809 S0006581532\_V2

*M. P. 11/10*

Figure 401. Forward Trunnion Housing Assembly Installation - Sheet 1  
TASK 57-16-01-000-801

*26/12/29*

PARTIAL SIGN OFF STATUS:

Item: \_\_\_\_\_ Completed through item: \_\_\_\_\_ Sign: \_\_\_\_\_

Item: \_\_\_\_\_ Completed through item: \_\_\_\_\_ Sign: \_\_\_\_\_

Rev # 44



Rev Date: Oct 17, 2024 PDT

Type: Routine Card

ATA: 32--

Flow:-

Work Area:-

FIG. EFFECTIVITY: JXB AMM EFFECTIVITY 004, 005, 007-009, 014 PRE SB 737-32-1448

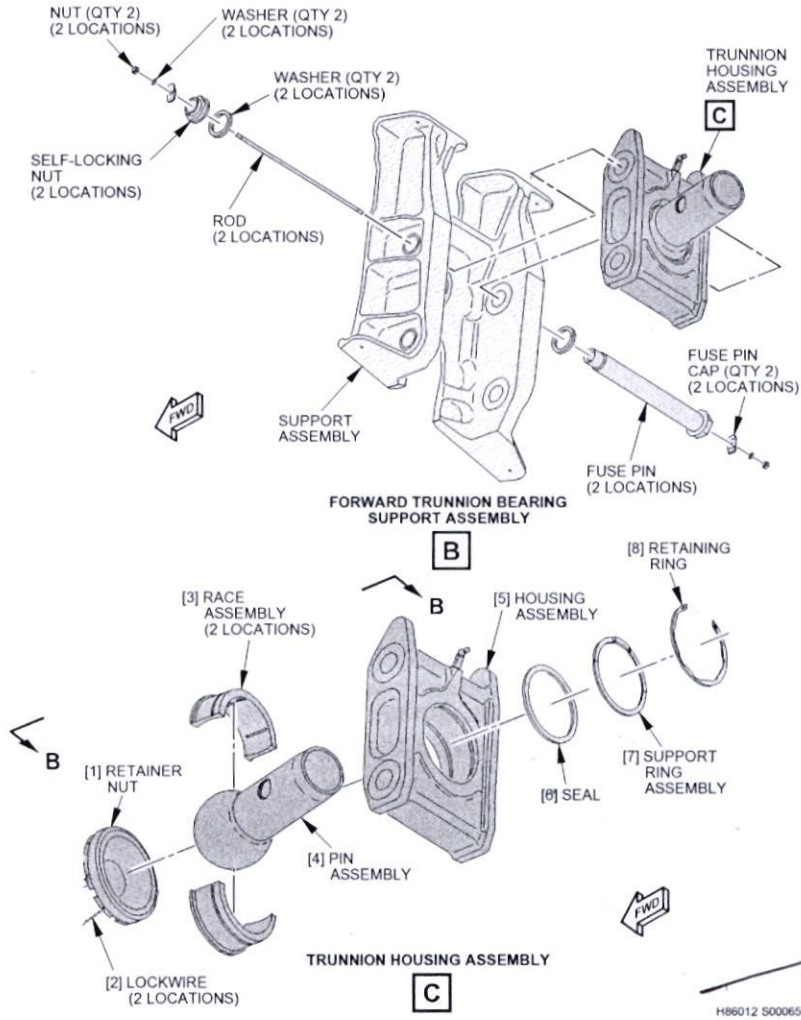

H86012 50006581533\_V5

*Handwritten signature/initials*

Figure 401. Forward Trunnion Housing Assembly Installation - Sheet 2  
TASK 57-16-01-000-801

*Handwritten signature*  
GAT 368

PARTIAL SIGN OFF STATUS:

Item: \_\_\_\_\_ Completed through item: \_\_\_\_\_ Sign: \_\_\_\_\_

Item: \_\_\_\_\_ Completed through item: \_\_\_\_\_ Sign: \_\_\_\_\_

Rev # 44



\* 3 2 - 0 4 0 - 0 1 - 0 1 \*

Rev Date: Oct 17, 2024 PDT

GCAA APPROVAL No : UAE.145.1232

737-600/700/800/900

Left Main Landing Gear Restoration

Type: Routine Card

ATA: 32--

Flow: -

Work Area: -

FIG. EFFECTIVITY: JXB AMM EFFECTIVITY 026-031, 033, 036, 037, 040-051, 053-999; JXB 004, 005, 007-009, 014 POST SB 737-32-1448

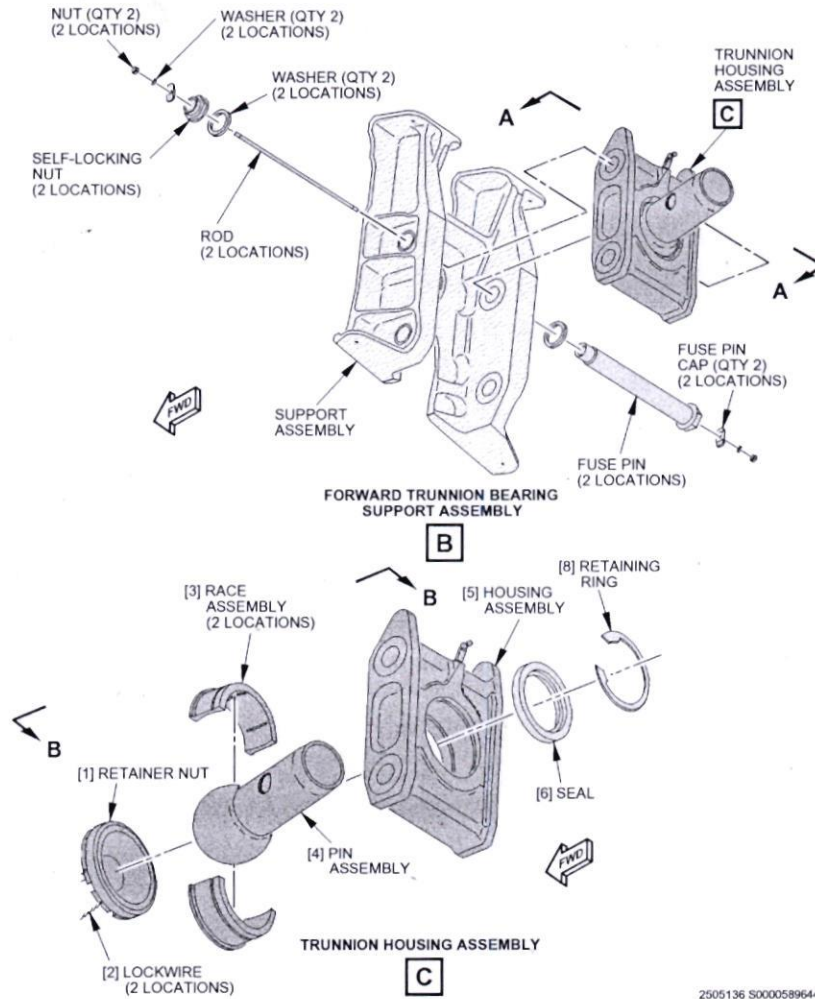

*MPIA*

Figure 401. Forward Trunnion Housing Assembly Installation - Sheet 3  
TASK 57-16-01-000-801

*25/12/20*

PARTIAL SIGN OFF STATUS:

Item: \_\_\_\_\_ Completed through item: \_\_\_\_\_ Sign: \_\_\_\_\_

Item: \_\_\_\_\_ Completed through item: \_\_\_\_\_ Sign: \_\_\_\_\_



Rev # 44



Rev Date: Oct 17, 2024 PDT

GCAA APPROVAL No : UAE.145.1232

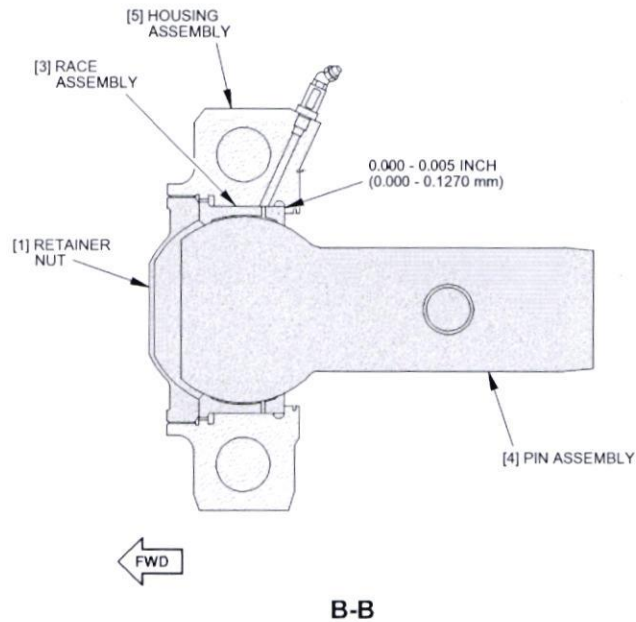

3013172 S0000786750\_V1

*M 11/100*

Figure 401. Forward Trunnion Housing Assembly Installation - Sheet 4  
TASK 57-16-01-000-801

*25/12/24*  
**GAT 368**

**PARTIAL SIGN OFF STATUS:**

Item: \_\_\_\_\_ Completed through item: \_\_\_\_\_ Sign: \_\_\_\_\_

Item: \_\_\_\_\_ Completed through item: \_\_\_\_\_ Sign: \_\_\_\_\_



FIG. EFFECTIVITY: JXB AMM EFFECTIVITY 026-031, 033, 036, 037, 040-051, 053-999; JXB 004, 005, 007-009, 014 POST SB 737-32-1448

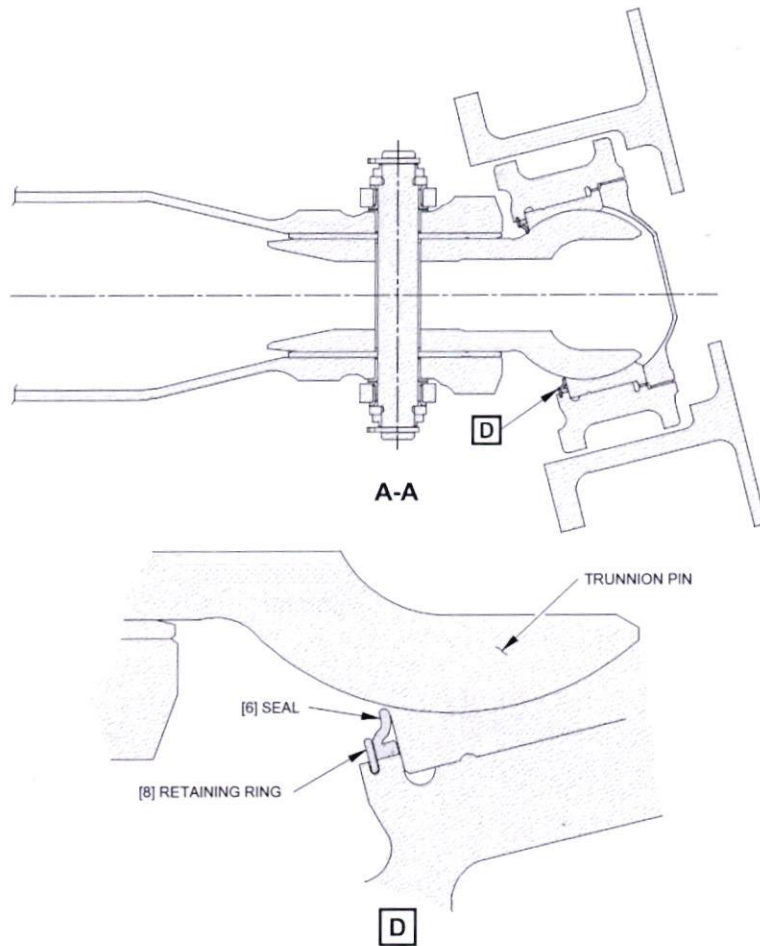

2554049 50000608759\_V1

*Mellaw*

Figure 401. Forward Trunnion Housing Assembly Installation - Sheet 5  
TASK 57-16-01-000-801

*25/12/20*  
*GAT*  
*368*

PARTIAL SIGN OFF STATUS:

Item: \_\_\_\_\_ Completed through item: \_\_\_\_\_ Sign: \_\_\_\_\_  
Item: \_\_\_\_\_ Completed through item: \_\_\_\_\_ Sign: \_\_\_\_\_

Rev # 44



Rev Date: Oct 17, 2024 PDT

GCAA APPROVAL No : UAE.145.1232

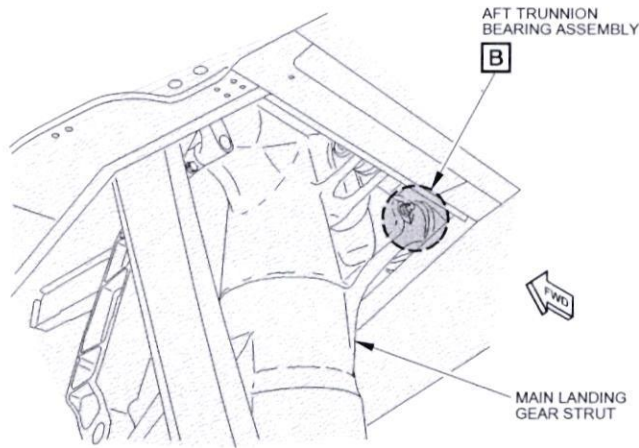
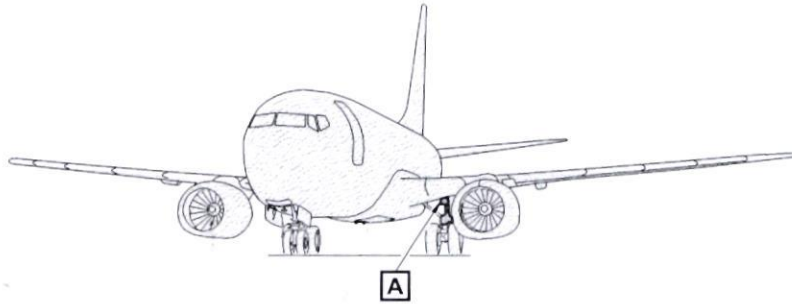

LEFT MAIN LANDING GEAR  
(RIGHT MAIN LANDING GEAR IS EQUIVALENT)

A

K22407 S0006581544\_V2

*Handwritten signature*

Figure 401. MLG Aft Trunnion Bearing Assembly Installation - Sheet 1  
TASK 57-16-02-000-801

GAT  
368

*Handwritten signature and date*  
25/12/24

PARTIAL SIGN OFF STATUS:

Item: \_\_\_\_\_ Completed through item: \_\_\_\_\_ Sign: \_\_\_\_\_

Item: \_\_\_\_\_ Completed through item: \_\_\_\_\_ Sign: \_\_\_\_\_

